

NAUTILUS XPLOAD

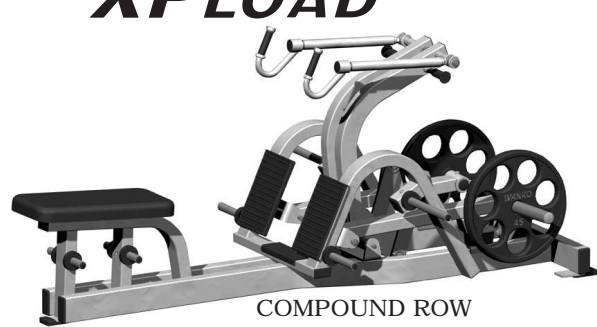

COMPOUND ROW



SEATED CALF



OVERHEAD PRESS



INCLINE PRESS



VERTICAL CHEST



LAT PULLDOWN



LEG PRESS



INCLINE LEG PRESS



BICEP CURL



LEG CURL PRONE



DEAD LIFT / SHRUG



TRICEP EXTENSION



SEATED DIP



LEG EXTENSION

NAUTILUS XPLOAD PARTS DIAGRAM

SEATED CALF

19-5218

REVISED:
February 6, 2006

PARTS AND SERVICE u 709 Powerhouse Road u Independence,
VA 24348

SERIAL # _____
through _____



P3SC FREEWEIGHT SEATED CALF

COMP#	COMPONENT DESCRIPTION	COMP#	COMPONENT DESCRIPTION
1	BSF226.....F2SC BASE FRAME	28	09-4075.....2 OD X 1 THK. RUBBER BUMPER, LORD
2	LK214.....F2SC STOP LEVER	29	09-4092.....BUMPER RETURN AIR#209
3	MA208.....F2SC WEIGHT ARM	30	09-5035.....MOLDED FOOTPADS
4	MA209.....F2SC LEG PAD MOUNT	31	09-5045.....FOOTPAD RECT (NEW)
5	MA210.....F2SC ADJUSTABLE LEG PAD MOUNT	32	09-8136.....T-KNOB YELLOW, 3/8-16 INSERT
6	01-0011.....BOLT HH5 1/2 X 3	33	09-9184.....1/4" X 1 1/2" PLASTIC CHANNEL X 14" LONG
7	01-1258.....BOLT HH5 1/2 X 3/4	34	12-1026.....KEEP HANDS AWAY(YELLOW)
8	02-9220.....BOLT HH5 3/8 X 1 1/4	35	12-1104.....DECAL SEAT BLACK 1-11 (1" INC.)
9	03-1035.....3/8 NUT	36	12-1380.....INSPECTION STICKER DECAL
10	03-9075.....NUT NTE 1/2-13	37	12-5356.....INSTRUCTIONAL PLACARD P3SC
11	04-3020.....3/8 LOK WASHER	38	12-1165.....WARNING DECAL FOR SELECTOR PIN
12	04-5214.....1/2 LOK WASHER	39	12-5149.....NAUTILUS "SIGNATURECAL" 2000 16 1/2" L.SMOKE
13	05-1190.....BRASS BUSHING .760 ID X 1 OD X 3/4 LONG	40	19-1012.....TAPE DOUBLE SIDED 1 1/2" 14" LONG
14	05-5116.....1 1/2 ID PLASTIC BUSHING, MODIFIED IGUS	41	19-1291.....DECAL SERIAL # BAR CODE
15	19-1575.....BEARING, 1" PLASTIC, FLANGE	42	19-1356.....SEATED CALF FOOT PLATE GRIP 1/8" DIAMOND TREAD ZINC
16	07-7095.....3/8 X 1 3/4" ROLL PIN	43	19-5218.....PARTS DIAGRAM P3SC
17	07-9286.....SLIDE FOR 2" TUBE	44	40-7167.....BAG 50 X 46 X 86 X .002 THICK
18	07-9287.....SLIDE GUIDES FOR 2" TUBE	45	UP9536.....KNEE PAD
19	07-9434.....BEARING SLEEVE, 3/4 X 1 7/8	46	UP9915.....SEAT PAD
20	07-9435.....LEG PAD SHAFT, 1 1/4 DIA X 15"	47	01-4041.....1/2 X 1 1/2 BOLT BUTTON HEAD
21	09-1058.....7/8 X 4 1/2 OPEN END HAND GRIP	48	07-4125.....PULL PIN UNIT
22	09-1105.....1 1/8 X 5 HAND GRIP	49	03-4142.....5/16 JAM NUT
23	09-2090.....PLUG, FRAME, 2X3	50	09-9525.....1.75" END CAP
24	09-3055.....2 X 4 FRAME PLUG	51	09-9555.....1.75" RING
25	09-3075.....PLUG, HOLE 1-1/4 ID X 1-3/8 OD	52	09-9620.....TUBE INSERT
26	09-3092.....1 1/4 OD X 1.00 ID X .750 LONG HOLE PLUG	53	02-2290.....1/4 X 1 AFH SCREW
27	09-4068.....WEIGHT STORAGE, 3/4 X 3" OD RUBBER	54	02-3055.....1/4-28 X 1/4 SET SCREW



RED: PAINTED ITEMS
____ Trolleys / Machine

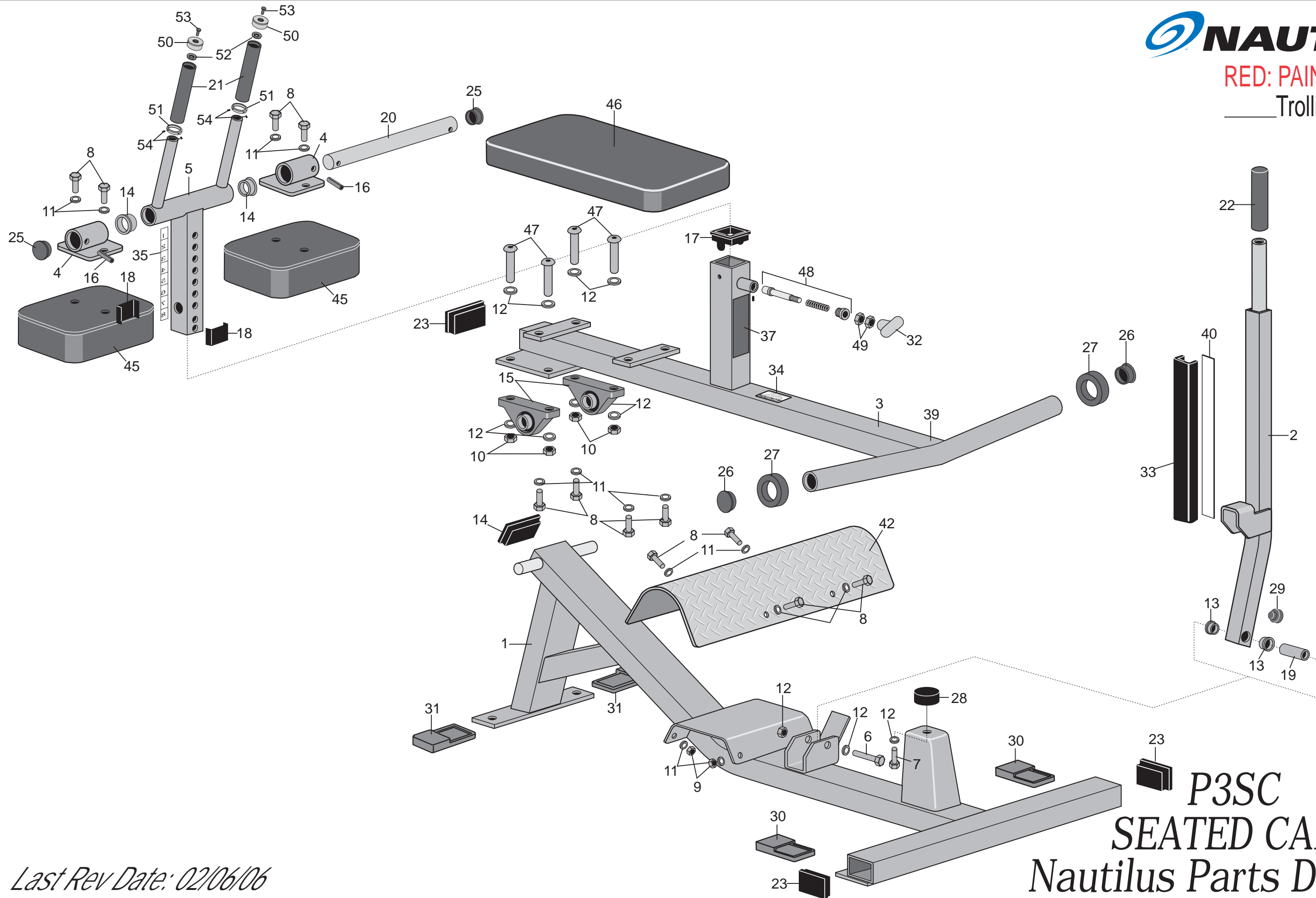

P3SC SEATED CALF Nautilus Parts Diagram

Last Rev Date: 02/06/06